



Vent Door Latch Assembly Instructions

CH-9225 Bill of Material:

Item	Description	Qty
1	Calf-Tel Warm Weather Latch	1
2	¼-20 x 2" Hex Head Cap Screw, YZ	1
3	¼-20 Nylon Insert Lock Nut YZ	1
4	¼ USS Flat Washer YZ	2
5	Assembly Instruction Sheet	1

Tools Needed:

1. (2) 5/16" Deep Well sockets
2. (2) Ratchets

Note Latch is used on both Calf-Tel Hutch and MultiMax

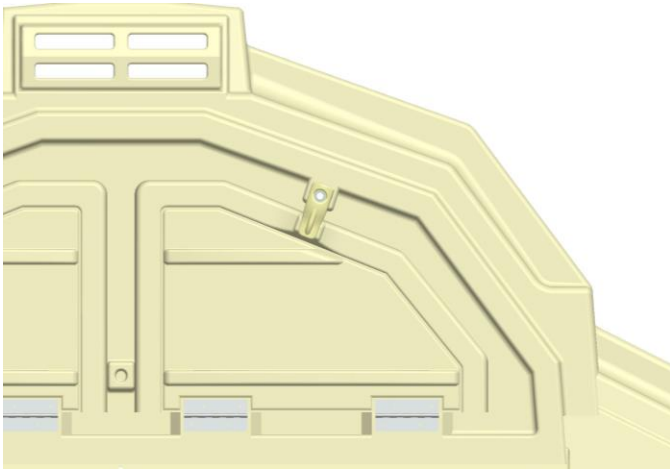

MultiMax Installation

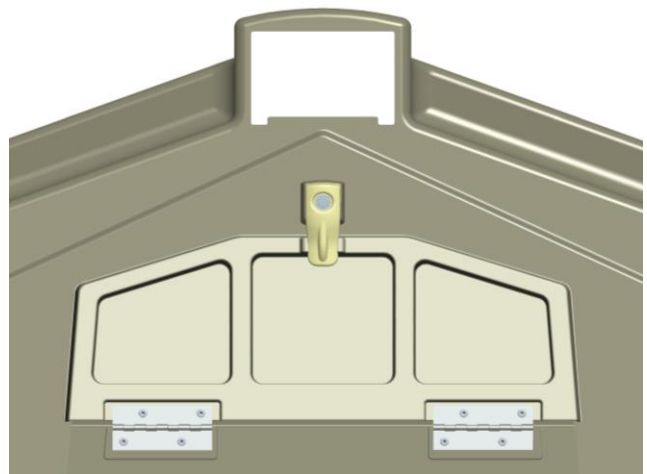

Calf-Tel Installation

Exploded View

