

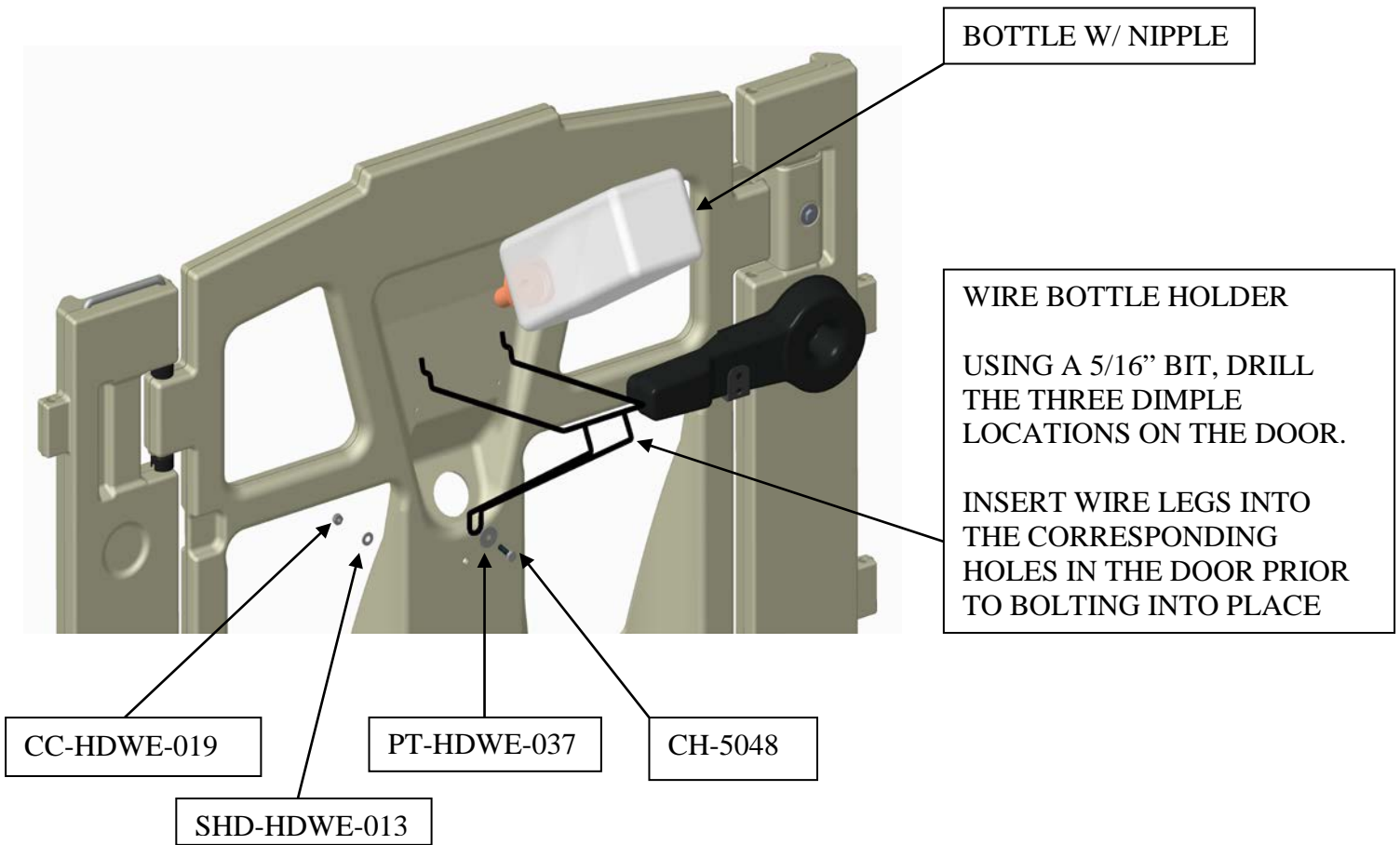

OPTIONAL BOTTLE HOLDER ASSEMBLY



INSTALL THE 1" CAP SCREW (CH-5048) AND THE 1" DIA. WASHER (PT-HDWE-037) THROUGH THE BOTTOM LOOP OF THE WIRE BOTTLE HOLDER.

USING THE SMALL FLAT WASHER (SHD-HDWE-013) AND THE NYLON LOCK NUT (CC-HDWE-019) TIGHTEN THE WIRE BOTTLE HOLDER TO THE PLASTIC DOOR.

SEE ABOVE